

# FEROZ GANDHI NAGAR RAE BARELI

TO RAE BARELI

MAIN ROAD

TO LUCKNOW

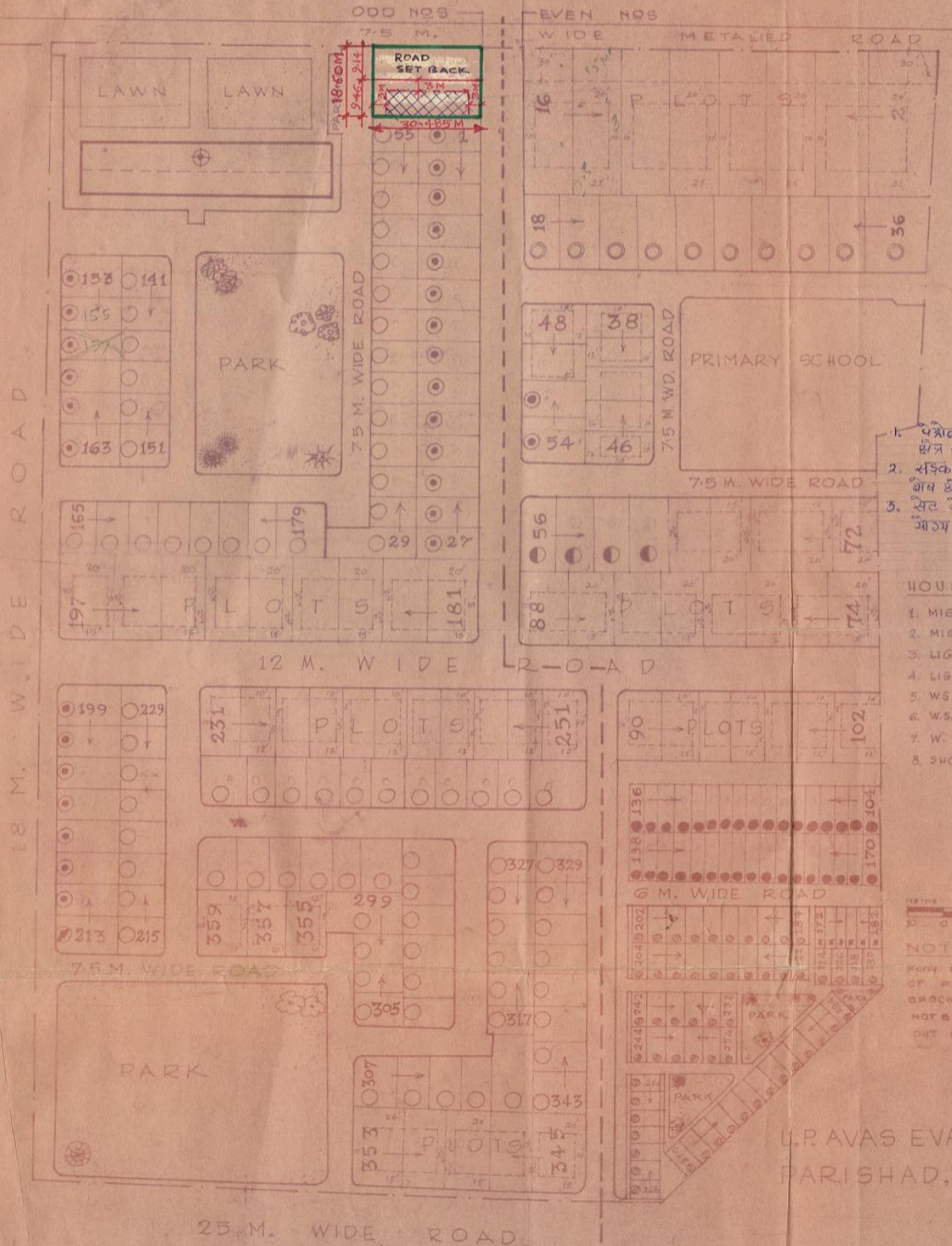

1. पत्रोल पत्र के लिये आरक्षित क्षेत्र = 30.485 X 18.00 मी.
2. सड़क के लिये मर्मि डिज़िन के परवाना क्षेत्र = 30.485 X 9.40 मी.
3. सिट बैक डिज़िन के परवाना निर्माण आरक्ष क्षेत्र = 24.485 X 6.40 मी.

**HOUSES:**

- |                     |        |   |
|---------------------|--------|---|
| 1. MIG 1/73 HOUSES  | 10 NOS | ○ |
| 2. MIG 2/73 HOUSES  | 4 "    | ○ |
| 3. LIG 1/73 HOUSES  | 82 "   | ○ |
| 4. LIG 3/73 HOUSES  | 30 "   | ○ |
| 5. W.S. 2/73 HOUSES | 34 "   | ○ |
| 6. W.S. 3/73 HOUSES | 6 "    | ○ |
| 7. W. 1/73 HOUSES   | 56 "   | ○ |
| 8. SHOPPING CENTRE  | 1 "    | + |



**NOTE:**  
FOR THE SHAPES AND SIZES OF PLOTS REFER ALLOTMENT OR CROSS DIMENSIONING SHOULD NOT BE MEASURED IN THIS LAYOUT PLAN.

U.P. AVAS EVAM VIKAS PARISHAD, LUCKNOW